

# AMPLIFY

## ASSEMBLY INSTRUCTIONS

The sleek, aerodynamic design gives Amplify® power with the appearance of smart no-nonsense efficiency and comfort. The supportive back with lumbar support, three application-specific arm types and waterfall seat add great ergonomics and comfort to the equation. The curvaceous profile and soft, textured arm pads make this a collection that delivers style as well as substance.

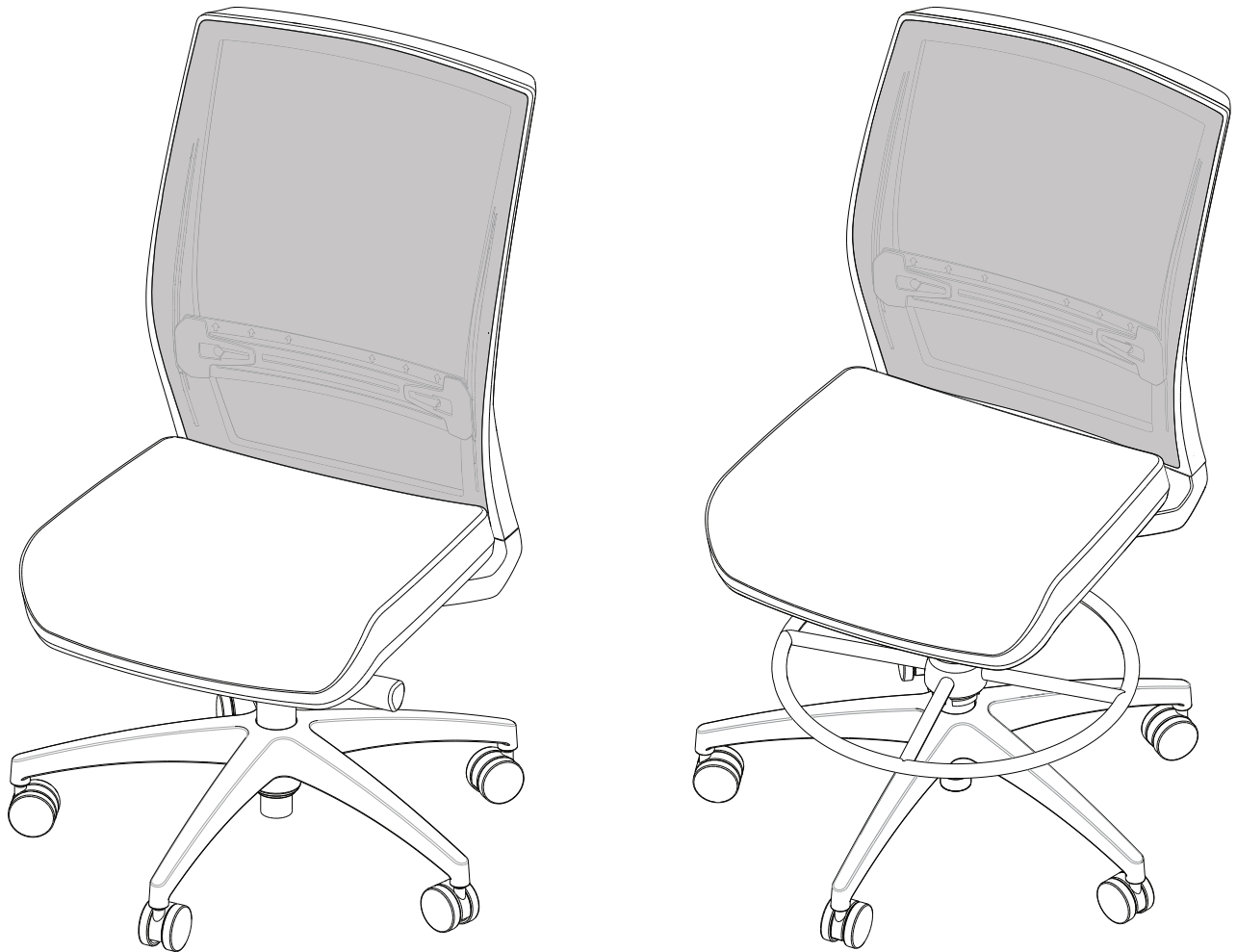



# AMPLIFY ASSEMBLY INSTRUCTIONS

## 1 ENHANCED SYNCHRO MECHANISM

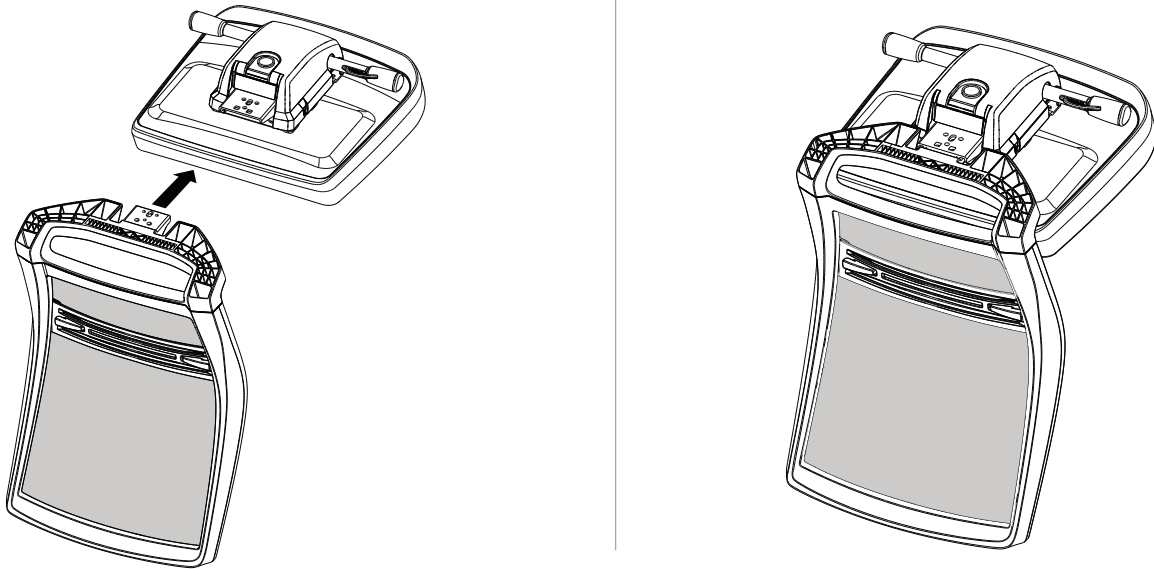

## 2 Seat Assembly

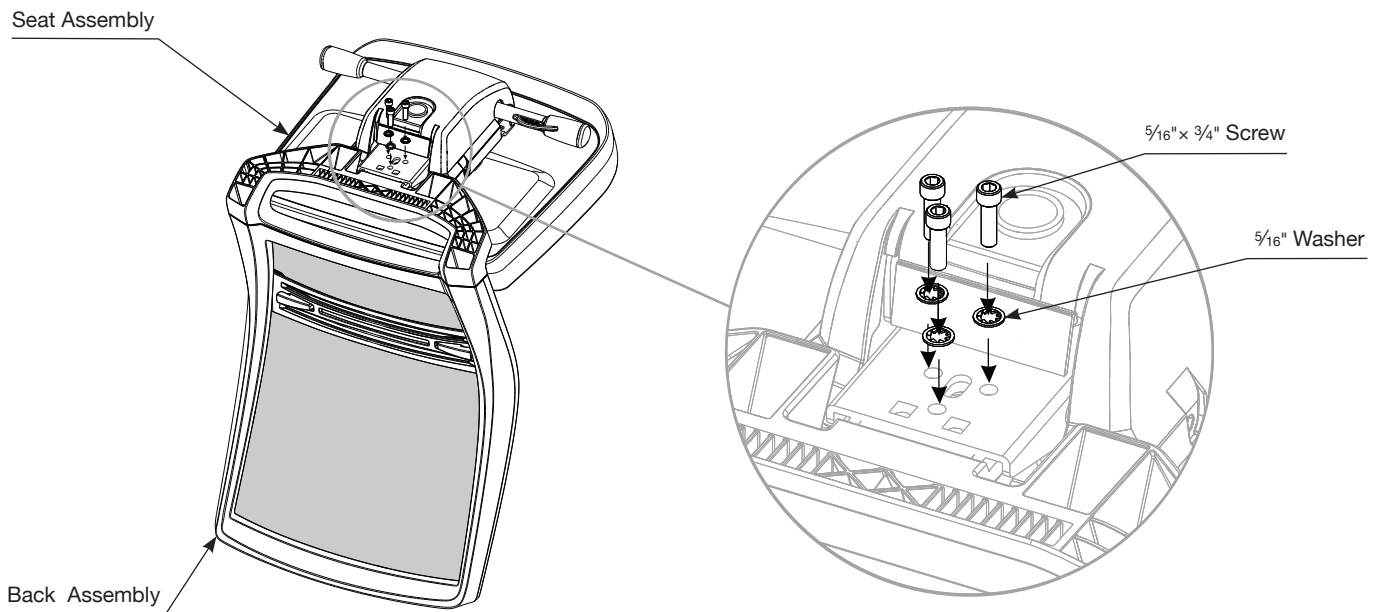

## STEPS

1. Place seat/mechanism assembly on a firm, flat surface. Locate back assembly by sliding in bracket and following hole pattern.
2. Secure back assembly by tightening three  $\frac{5}{16}$ "  $\times$   $\frac{3}{4}$ " screws and three  $\frac{5}{16}$ " washers using a  $\frac{1}{4}$ " hex L-key to a minimum torque of 150 in-lb.

# AMPLIFY ASSEMBLY INSTRUCTIONS

## 1 BASIC OR SWIVEL TILT MECHANISM

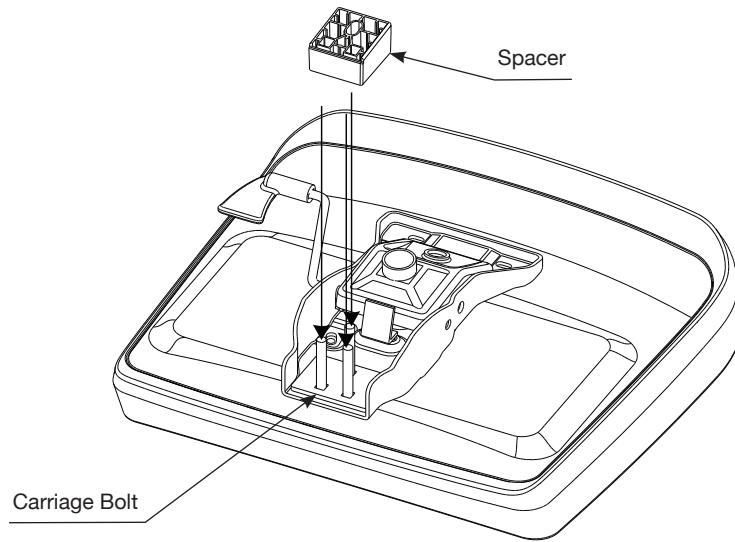

## 2

Back Assembly

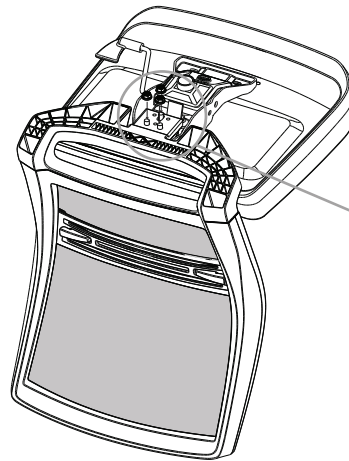
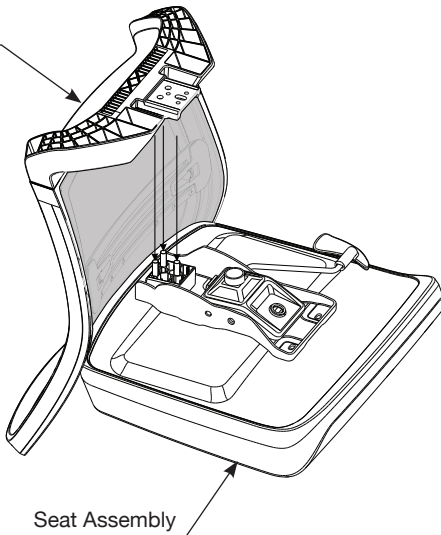

$\frac{3}{8}$ " Nut

## STEPS

1. Place seat/mechanism assembly on a firm, flat surface. Locate spacer by sliding it onto the three carriage bolts and following hole pattern.
2. Locate back assembly by following hole pattern over spacer. Secure the back assembly by threading three  $\frac{3}{8}$ " nuts onto the carriage bolts and tighten them using a  $\frac{9}{16}$ " crescent wrench to a minimum torque of 150 in-lb.

# AMPLIFY BASE ASSEMBLY INSTRUCTIONS

1

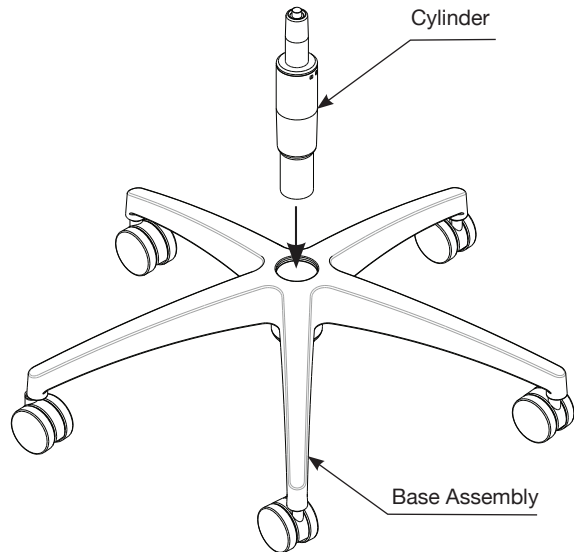

2

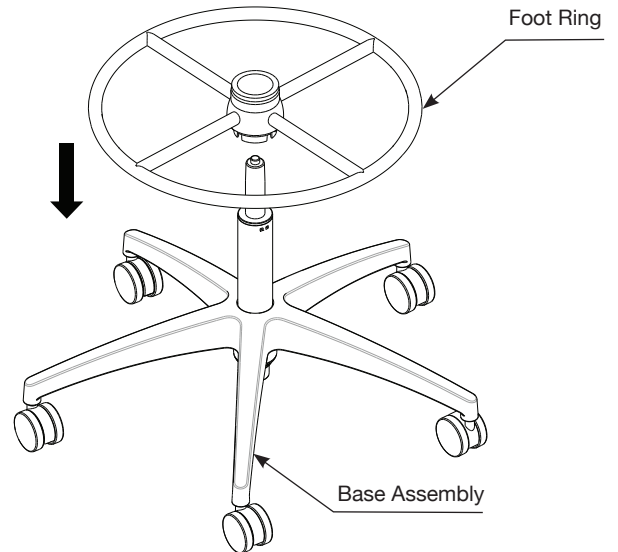

3

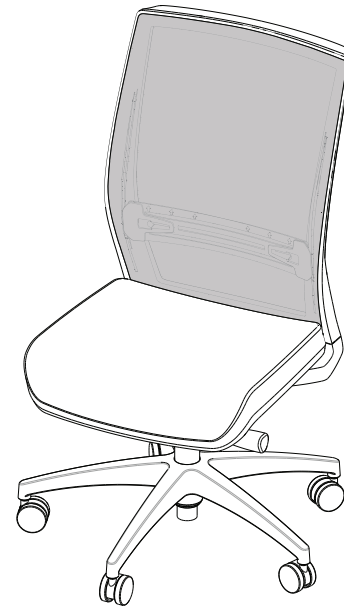
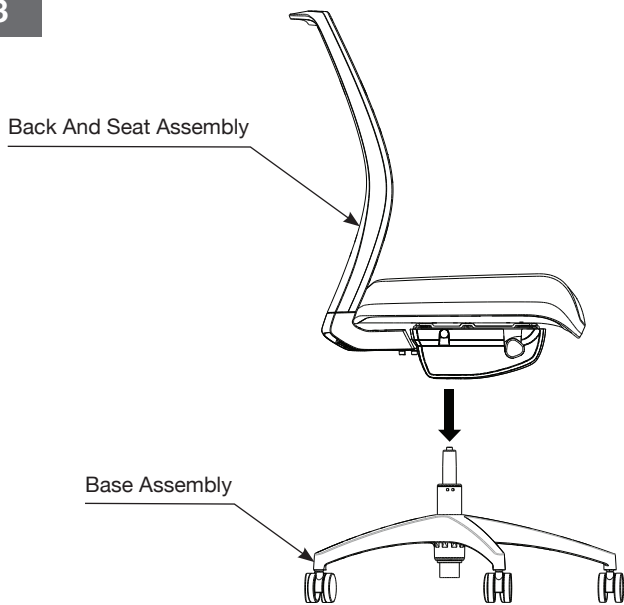

## STEPS

1. Slide the cylinder into the center of the base assembly and give it a push to seat it into position.
2. For stool version: Slide the foot ring over the cylinder until it is in the desired position. Follow the instructions in the foot ring package to tighten into place
3. With the base assembly sitting on the floor, firmly hold the seat and back assembly, align the mechanism's cylinder mounting hole with the top of the cylinder and push in place until seated. The cylinder is seated when you can lift the chair and the cylinder stays attached to the mechanism.