

Sprout

MULTIPURPOSE CHAIR

*It's friendly—
ergo and eco.*

The supportive, flexing back on Sprout™ provides extra ergonomics while the simple shell + frame construction makes it 100% recyclable (and super easy to maintain). It pairs a refined silhouette with rugged durability and stacks higher than any other chair we have. Whether spread out, stacked up or stored away, Sprout is always ready to thrive.



Better
Featured with the Navy shell

Featured Models

GOOD :: \$240

Plastic seat and back, armless, wire rod base, no glides

BETTER :: \$249

Plastic seat and back, armless, wire rod base, clear glides

Features

- Space-saving design features high-density stacking (up to 40 on a cart and 10 on the floor)
- Ergonomic contouring with 10-degree flexing back provides superior comfort
- Durable and simple shell + frame construction means it's easy to maintain—and is 100% recyclable when it's time to replace
- Slim lines and silhouette complement an array of environments
- Large clean-out makes clean-up quick
- Ganging option locks chairs together effortlessly, creating well-ordered rows for seating
- Nine shell colors and two frame colors
- 300 lb weight capacity warranty

1. Frame

Frame Type	Code	Price	
------------	------	-------	--

Wire Rod Chair

1181 FT2

\$240



Frame Finish	Code	Price	
--------------	------	-------	--

Black

FC1

+ \$0

Chrome

FC15

+ \$0

2. Seat and Back

Seat	Code	Price	
------	------	-------	--

Plastic

PS

+ \$0



Back	Code	Price	
------	------	-------	--

Plastic

PB

+ \$0

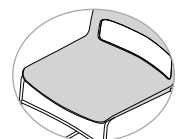

MULTIPURPOSE CHAIR

3. Arms

Arm Style	Code	Price	
-----------	------	-------	--

Armless

AR0

+\$0



4. Base

Glides	Code	Price	
--------	------	-------	--

No Glides

G0

+\$0

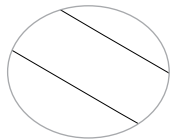

Clear Glides

CGR

+\$9

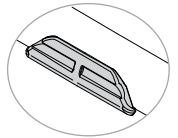

Clear Glides With Felt

CGRF

+\$27

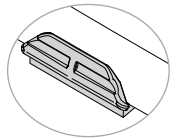

5. Miscellaneous

Accessories	Code	Price	
-------------	------	-------	--

Ganging Bracket

GG

+\$30

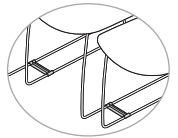

Stacking Cart

CART

+\$399

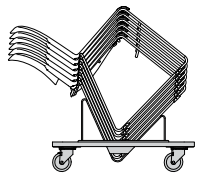

Stacking carts require assembly.

See [page 135](#) for additional stacking requirements.

6. Material

Shell Color	Code	Price	
Arctic	SC21	+\$0	
Black	SC1	+\$0	
Chocolate	SC4	+\$0	
Lagoon	SC15	+\$0	
Latte	SC20	+\$0	
Navy	SC5	+\$0	
Red	SC19	+\$0	
Slate	SC8	+\$0	
Sterling	SC18	+\$0	

7. Packaging

Packaging	Code	Price	
Fully Assembled In a Carton	AC	+\$0	
Fully Assembled in a Carton, Individually Packaged	AC1	+\$20	

SPECIFICATIONS

	Wire Rod 1181 FT2
Dimenions	
Overall Width	21.25"
Overall Depth	22"
Overall Height	32"
Seat Width	18.75"
Seat Depth	16"
Seat Height	18.5"
Back Width	18.5"
Back Height	16"
Stacking	
Maximum Floor Stacking	10
Maximum Cart Stacking	40
Dimenions	
Weight	14.5 lb
Weight Capacity Warranty	300 lb



Stacking Cart